

3 Days 2 Nights

Genting First World Hotel

三天两晚云顶第一大酒店

Auspicious Package

Package Include 包括包括:

- ✓ **Return Coach**
Singapore – Genting – Singapore
来回车程新加坡 – 云顶 – 新加坡
- ✓ **Two Night Stays At First World Hotel**
两晚住宿于第一大酒店
- ✓ **Coach Insurance**
巴士保险

Open Dated Theme Park Tickets
日期开放式主题公园门票 \$43



Resorts World
GENTING

Member Price



\$888

Per Pax From 每人起
Till 直 31 Mar 25

Business Account



WhatsApp +65 8710 7707



www.707-inc.com

Favored ★★★★★ Sold 98 888

所提供的行程及价格仅供参考，最终行程可能根据实际情况进行调整。受条款及细则约束。*

The provided itinerary and price are for reference purposes only; the final itinerary may be adjusted based on the actual circumstances. Terms and conditions apply. *

3 Days 2 Nights



Genting First World Hotel

三天两晚云顶第一大酒店



Season 季节	Low 淡季	Peak 旺季	Super 超旺	High 巅峰	Lucky Room 幸运房 Per Room Per Night 每间客房每晚 30 40 60 100
Twin sharing 两人一房	\$ 88	\$ 98	\$ 138	\$ 198	
Single Room 单人房	\$ 108	\$ 128	\$ 188	\$ 258	
Extension / RM / NT 延长住宿 / 房 / 晚	\$ 20	\$ 30	\$ 50	\$ 90	
Include 包括	<ul style="list-style-type: none"> Two Way Coach Singapore – Genting Two Night Stay At Genting (ROH) 			<ul style="list-style-type: none"> 新加坡 - 云顶 - 来回车程 两晚住宿于云顶 (ROH) 	
Exclude 除外	<ul style="list-style-type: none"> Travel Insurance Hotel Feasible Tax or Deposit 			<ul style="list-style-type: none"> 旅游保险 酒店入住税或酒店押金 	
Remark	<ul style="list-style-type: none"> Booking Is Subjected To Availability & Confirmation No Amendment Or Refund Suggest To Buy Travel Insurance Terms & Condition Apply 			备注 <ul style="list-style-type: none"> 一切预订以最终确认书为准 不可修改或退还 建议购买旅游保险 需符合条规 	

707-Inc Auspicious Package, Genting Member Only 去赢去-赢配套,云顶会员特价 Standard or Deluxe Room ROH Assign By Genting NO REQUEST

Open Dated Theme Park Tickets \$43 期开放式主题公园门票

October (十月) 2024							November (十一月) 2024							December (十二月) 2024						
Sun	Mon	Tue	Wed	Thu	Fri	Sat	Sun	Mon	Tue	Wed	Thu	Fri	Sat	Sun	Mon	Tue	Wed	Thu	Fri	Sat
		1	2	3	4	5						1	2	1	2	3	4	5	6	7
6	7	8	9	10	11	12	3	4	5	6	7	8	9	8	9	10	11	12	13	14
13	14	15	16	17	18	19	10	11	12	13	14	15	16	15	16	17	18	19	20	21
20	21	22	23	24	25	26	17	18	19	20	21	22	23	22	23	24	25	26	27	28
27	28	29	30	31			24	25	26	27	28	29	30	29	30	31				
January (一月) 2025							February (二月) 2025							March (三月) 2025						
Sun	Mon	Tue	Wed	Thu	Fri	Sat	Sun	Mon	Tue	Wed	Thu	Fri	Sat	Sun	Mon	Tue	Wed	Thu	Fri	Sat
			1	2	3	4							1	30	31					1
5	6	7	8	9	10	11	2	3	4	5	6	7	8	2	3	4	5	6	7	8
12	13	14	15	16	17	18	9	10	11	12	13	14	15	9	10	11	12	13	14	15
19	20	21	22	23	24	25	16	17	18	19	20	21	22	16	17	18	19	20	21	22
26	27	28	29	30	31		23	24	25	26	27	28		23	24	25	26	27	28	29

707 Inc **WhatsApp +65 8710 7707**

所提供的行程及价格仅供参考，最终行程可能根据实际情况进行调整。受条款及细则约束。*

The provided itinerary and price are for reference purposes only; the final itinerary may be adjusted based on the actual circumstances. Terms and conditions apply. *

Genting First World Hotel

云顶第一大酒店

3 Days 天
2 Nights 夜

Low 淡季

\$88 Per Pax Twin 两人一房
\$108 Per Pax Single 单人房

Peak 旺季

\$98 Per Pax Twin 两人一房
\$128 Per Pax Single 单人房

Super 超旺季

\$138 Per Pax Twin 两人一房
\$188 Per Pax Single 单人房

High 巅峰季

\$198 Per Pax Twin 两人一房
\$258 Per Pax Single 单人房

\$ Per Pax From 每人起

Additions x 1 Night

延长住宿 x 1 夜

Low 淡季

\$10 Per Pax Twin 两人一房
\$20 Per Pax Single 单人房

Peak 旺季

\$15 Per Pax Twin 两人一房
\$30 Per Pax Single 单人房

Super 超旺季

\$25 Per Pax Twin 两人一房
\$50 Per Pax Single 单人房

High 巅峰季

\$45 Per Pax Twin 两人一房
\$90 Per Pax Single 单人房

\$ Per Pax From 每人起



Business Account

WhatsApp +65 8710 7707



www.707-inc.com

Favored ★★★★★ Sold 98 888

所提供的行程及价格仅供参考，最终行程可能根据实际情况进行调整。受条款及细则约束。*

The provided itinerary and price are for reference purposes only; the final itinerary may be adjusted based on the actual circumstances. Terms and conditions apply. *

Genting Coach Schedule - Daily Departure

云顶 - 时间表每日出发

Departure 出发新 - 马 SG - MY	Singapore SG 新加坡	↔	Genting MY 云顶	Return 回程马 - 新 MY - SG
	Alight 下车 : Hilltop Bus Terminal BT3			
6:40 AM	People's Park Centre 168 Coffee Shop 牛车水珍珠大厦 168 咖啡店			12:00 PM 03:15 PM
7:00 AM 10:30 PM	Kovan Interchange Bus Terminal 高文巴士转换站			10:45 AM 12:05 PM
7:20 AM 9:00 PM	Ban San Street / Queen Street 170 Bus Terminal 万山街 / 奎因街 170 巴士总站			10:00 AM 12:20 PM
7:05 AM 9:15 PM	Boon Lay Shopping Centre @ Savoy Theatre 文礼购物中心 @ Savoy Theatre			10:05 AM 12:15 PM
7:35 AM	Jurong East Genting Hotel Side Road 裕廊东云顶酒店路旁			10:45 AM 12:10 PM 1:30 PM
10.10 AM * 11:00 PM	Harbourfront Centre Coach Bay 1 2 3 港湾中心巴士停车场 1 2 3			10:30 AM 1:30 PM
	Singapore SG 新加坡	↔	Resort World Awana MY	
	Alight 下车 : Resort World Awana			
10:10 AM	Harbourfront Centre Coach Bay 1 2 3 港湾中心巴士停车场 1 2 3			NIL*
	Malacca 马六甲	↔	Genting 云顶	
10:05 AM	707 Hub / Estadia / Hatten Hotel Coach Bay 马六甲 707 中心 / 雅胜 / 惠胜酒店巴士总站			12:00 PM 3:30 PM

所提供的行程及价格仅供参考，最终行程可能根据实际情况进行调整。受条款及细则约束。*

The provided itinerary and price are for reference purposes only; the final itinerary may be adjusted based on the actual circumstances. Terms and conditions apply. *

Interior 内部 (2 + 1) 27 - 30 Seater 座位



Coach Fleets 车队



Gold Class



Recline Seat



USB



Wifi



Air Suspensions

*****Free WIFI And USB Ports Are Available On Select Coaches Only.*****

We Are On The Verge Of Upgrading Our Coach Fleet. *Terms Applies Please Take Note : Product Images Are For Illustrative Purposes Only.

*****仅部分车厢提供免费 WIFI 和 USB 端口。*****

我们即将升级我们的客车车队。 *适用条款请注意：产品图片仅供说明之用。

行程仅供参考, 最终行程可能会根据实际情况进行微调。须符合条规

The itinerary is for reference only, the final itinerary may be fine-tuned according to the actual situation. Terms Apply*



First World Hotel Standard Room Ideal For Two Adults Only



Features

- **No frills, practical, compact room**
- **Ideal for two adults only**
- **WiFi coverage at lobby level only, upon purchase at Information Counter**
- **Located at Tower 1**
- **Average room size: 180 sq. ft.**

Amenities

- **In-room safe**
- **Telephone**
- **Standing shower**
- **Hair dryer**
- **Three-in-one shampoo**
- **Hot and cold water dispenser located along floor corridor**
- **Not provided in room - Toiletry set, mineral water, coffee and tea sachet can be purchased at the vending machine located at the lobby lift landing**

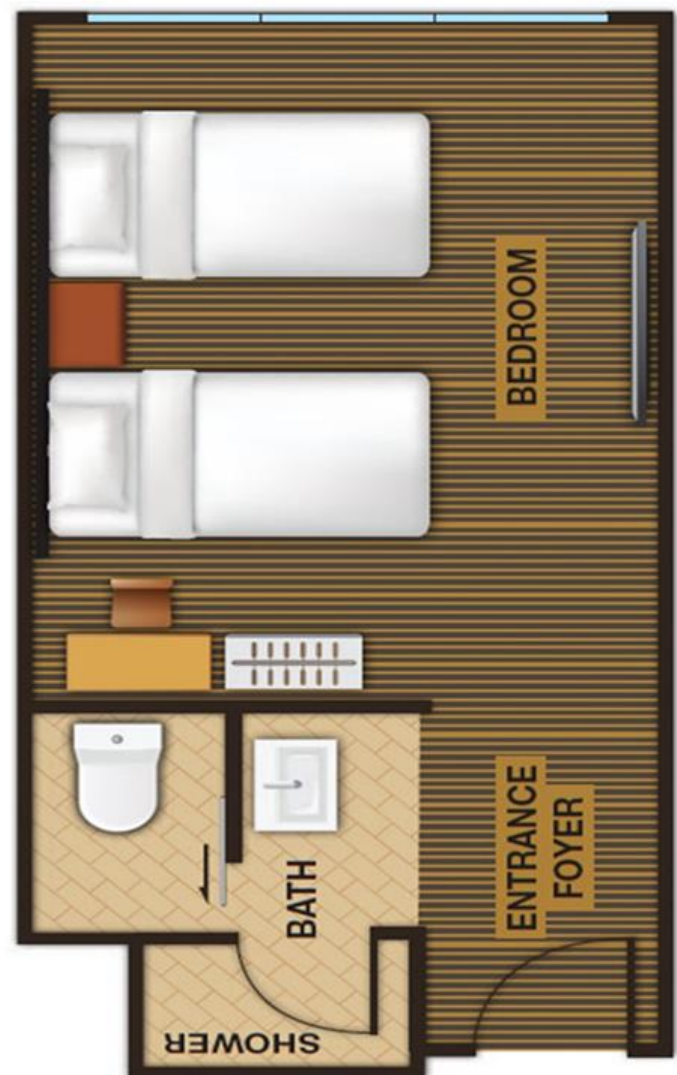

所提供的行程及价格仅供参考，最终行程可能根据实际情况进行调整。受条款及细则约束。*

The provided itinerary and price are for reference purposes only; the final itinerary may be adjusted based on the actual circumstances. Terms and conditions apply. *



First World Hotel Deluxe Room With Mini Fridge Ideal For Two Adults Only



Features

- **No frills, practical, compact room**
- **Ideal for two adults only**
- **WiFi coverage at lobby level only, upon purchase at Information Counter**
- **Located at Tower 2**
- **Average room size: 180 sq. ft.**

Amenities

- **In-room safe**
- **Flat screen TV**
- **Telephone**
- **Standing shower**
- **Hair dryer**
- **Tea and coffee-making facilities**
- **3-in 1 Liquid Soap**
- **Kettle**
- **Mini fridge**
- **Not provided in room -Toiletry set, mineral water, coffee and tea sachet can be purchased at the vending machine located at the lobby lift landing**

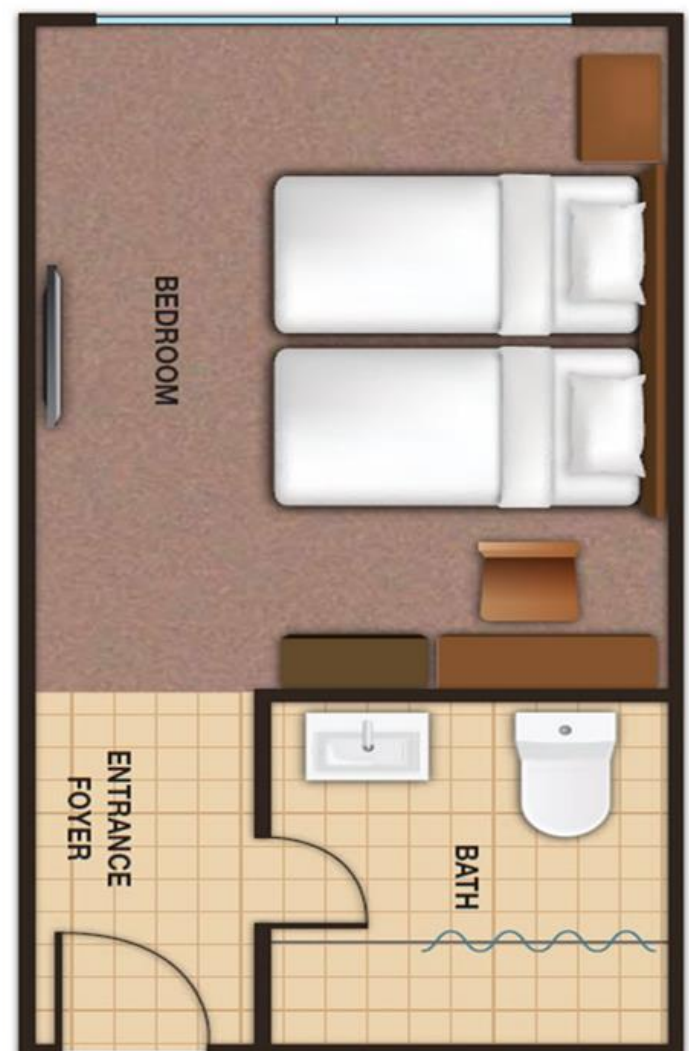

所提供的行程及价格仅供参考，最终行程可能根据实际情况进行调整。受条款及细则约束。*

The provided itinerary and price are for reference purposes only; the final itinerary may be adjusted based on the actual circumstances. Terms and conditions apply. *

First World Hotel

第一大酒店



World's largest hotel with the best value

The world's largest hotel offers an astronomical 7,351 rooms, a wide selection to spoil travellers of every budget.

First World Hotel is situated at the heart of Resorts World Genting, giving guests easy access to key locations such as the First World Plaza, SkyAvenue, Skytropolis Indoor Theme Park, and Genting International Convention Centre.

所提供的行程及价格仅供参考，最终行程可能根据实际情况进行调整。受条款及细则约束。*

The provided itinerary and price are for reference purposes only; the final itinerary may be adjusted based on the actual circumstances. Terms and conditions apply. *



707-Inc Xpress

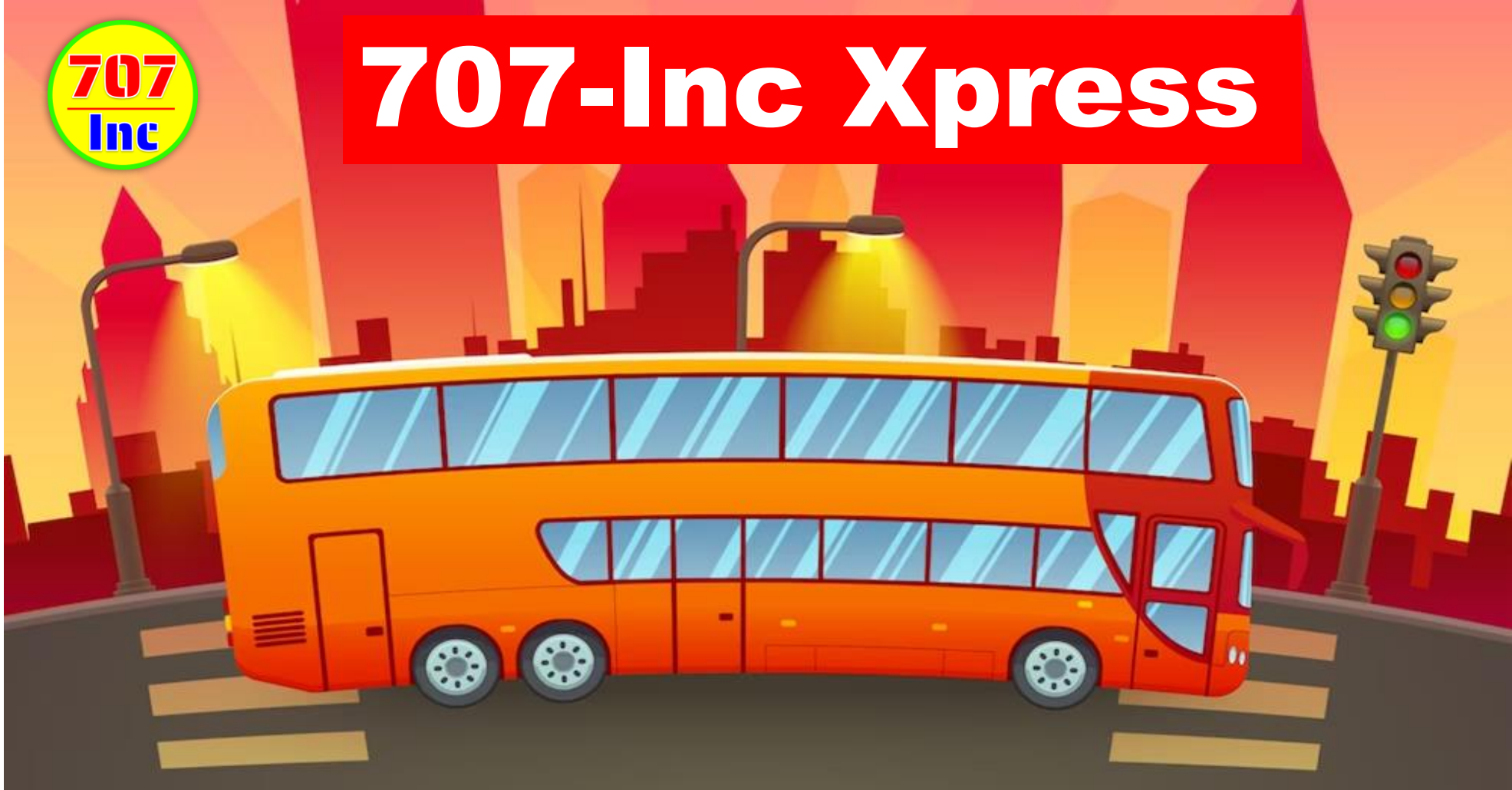

✓ **Included**

✓ **Coach Insurance**

✓ **Coach Transfer**

✓ **Hotel**

✗ **Excluded**

✗ **Travel Insurance**

✗ **Hotel Tax**

Coach Insurance 巴士上保險 Policy Schedule

For The Benefit Of: Coach Passengers Of The Policyholder Departure <u>Singapore</u> / Return <u>Singapore</u> ONLY 有效:新加坡出发 / 返回新加坡	Maximum Benefit Limit Payable Per Insured Person \$ SGD Singapore Dollars
1. Accidental Death & Permanent Disablement * 80 Years Old Above Coverage \$12,500	\$ 25,000
2. Accidental Medical Expenses	\$ 2,000
3. Emergency Medical Evacuation	\$ 1,000
4. Loss Of Baggage Due To Thief, Burglary Or Robbery (Police Report Required) 需要警方报告	\$ 200

Coverage: Underwritten By Chubb Insurance.

NOT Valid For Malaysia Interstate Travelers

One Way \$5.00

Two Way \$10.00

所提供的行程及价格仅供参考，最终行程可能根据实际情况进行调整。受条款及细则约束。*

The provided itinerary and price are for reference purposes only; the final itinerary may be adjusted based on the actual circumstances. Terms and conditions apply. *

Genting 云顶 707-Inc

Board And Alight Same Location.

Check In At Genting Main Terminal (Hilltop) 707-Inc Counter No. 1 (One) For Bus Number.
Present Your Voucher With Name, Date, Time, and Seat Number To Ground Crew Before Boarding.

在同一地点上车和下车。

请在云顶山顶巴士总站 707-Inc柜台一号报到及询问巴士号码。

在报到时, 请向707-Inc的工作人员出示您包含姓名、日期、时间和座位号的订单



www.707-inc.com

Check In

提早前往办理报到手续

30 Min



Genting Main Terminal (Hilltop)
Board and Alight Point
云顶山顶巴士总站BT3
上下车地点

LEGEND 图例



Parking 停车场



Hilltop Bus Terminal 山顶巴士总站

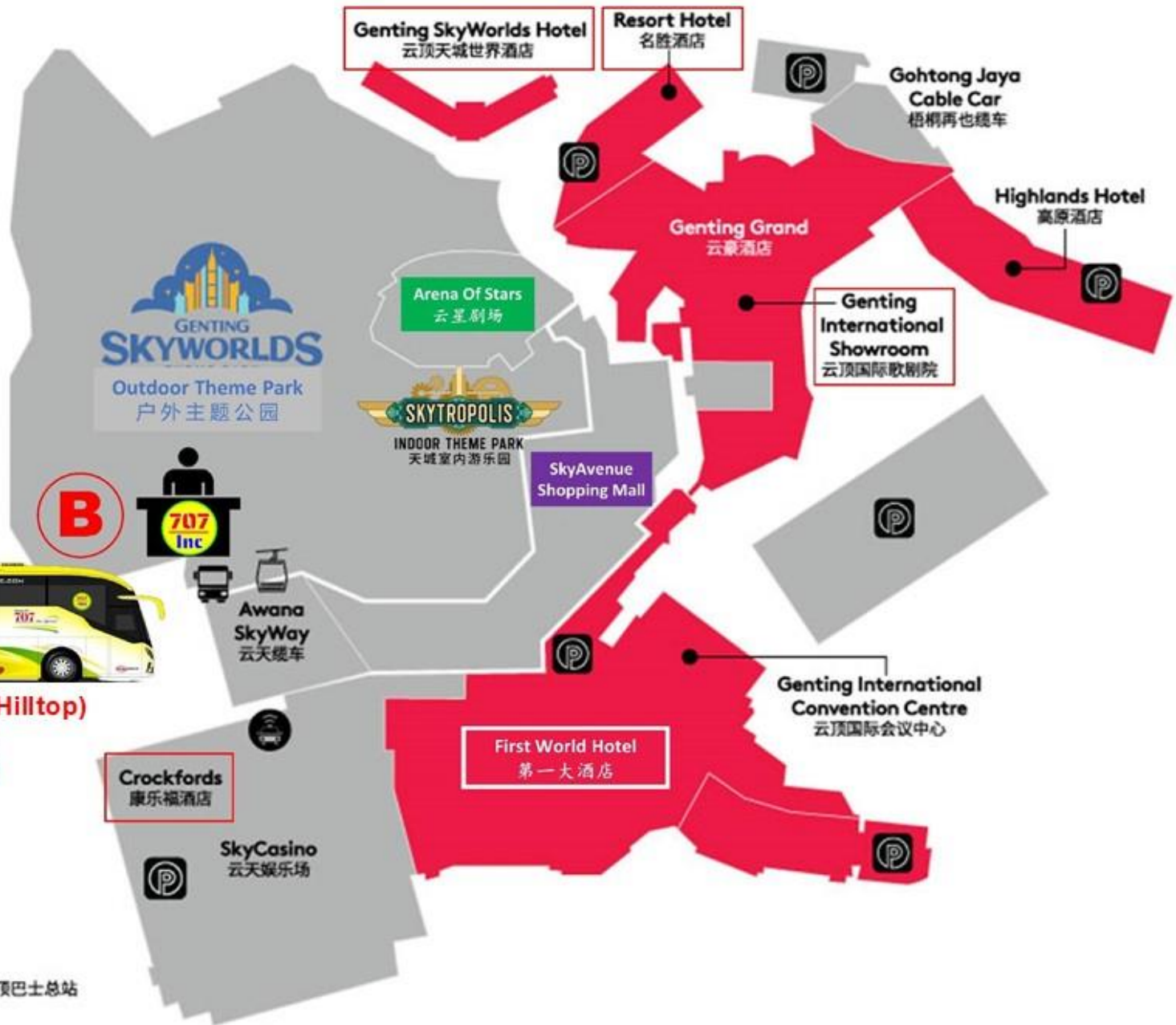

Genting Main Terminal (Hilltop) BT3 / Sky Avenue / Crockfords / First World
Are The Same Location 都在同一位置

Whatsapp Messages Only SG +65 8737 7707. Travel Info: www.707-inc.com/info

Daily 10:00 AM – 4:00 PM



Genting Main Terminal (Hilltop)
Bus Check In / Concert & Events
Redemption Counter

707-Inc No. 1 (One)

云顶山顶巴士总站
巴士车票 / 演唱会和特别活动
门票报到与兑换柜台
707-Inc 柜台一号



所提供的行程及价格仅供参考, 最终行程可能根据实际情况进行调整。受条款及细则约束。*

The provided itinerary and price are for reference purposes only; the final itinerary may be adjusted based on the actual circumstances. Terms and conditions apply. *



Genting 云顶

Place Of Interests

Skytropolis Indoor Theme Park
SkyWorlds outdoor Theme Park
Awana SkyWay
Genting Entertainment Facility
BigTop Video Games Park
Vision City Video Games Park
Sky VR
Genting Snow World
Ripley's Believe It Or Not
Genting Bowl

好玩景点

天城室内主题乐园
 天城世界主题乐园
 云天缆车
 云顶娱乐设施
 大本营电玩城
 梦幻电玩城
Sky VR
 云顶雪世界
 云顶信不信由你
 云顶保龄球场

Surrounding Explore

Chin Swee Caves Temple
Lim Goh Tong Memorial Hall
Genting Strawberry Leisure Farm
Gohtong Jaya
World of Phalaenopsis
Happy Bee Farm
Awana Horse Ranch

外围探索

清水岩庙
 林梧桐纪念馆
 云顶草莓园
 梧桐再也
 蝴蝶兰世界
 蜜蜂园
 牧马场

Food & Night Life Explore

Malaysian Food Street
Jom Makan Street Food
Genting Garden Hotpot
Starbucks Coffee
Han's Cha Chuan Teng
Burger & Lobster
Five Guys
Motorino Pizzeria
The Laughing Fish by Harry Ramsden
High Line
FUHU Restaurant
Zouk Genting
Cloud 9 Casual bar
Redtail Karaoke

美食与夜生活探索

马来西亚美食街
Jom Makan美食街
 云顶花园火锅
 星巴克咖啡
 汉记茶餐厅
 天台休闲美食街
 福虎餐厅
Zouk 夜店
Cloud 9 休闲酒吧
 卡拉ok

Shopping & Relax

SkyAvenue Complex
First World Complex
Genting Grand Complex
Genting Premium Outlets
Awana SkyCentral

购物与放松

云天综合大楼
 第一综合大楼
 云豪综合大楼
 云顶名牌折扣购物中心

所提供的行程及价格仅供参考，最终行程可能根据实际情况进行调整。受条款及细则约束。*

The provided itinerary and price are for reference purposes only; the final itinerary may be adjusted based on the actual circumstances. Terms and conditions apply. *



Resorts World
GENTING

FLASH

SALE

Open Dated
Theme Park Tickets

日期开放式

\$43 主题公园门票



SkyWorlds Theme Park: Theme Park Ride

www.gentingskyworlds.com/

- * SkyWorlds Outdoor Theme Park.
- * Redemption At 707- Inc Counter.
- * Closed Every Tuesday.
- * Except Malaysia Public Holidays.
- * No Amendment, Cancellation or Revalidate.
- * Ticket Sold NO REFUND. (Rain or Shine)

Auspicious Package

Dynamic Pricing Subject To Change, Limited Allotment

价格有变动的可能, 售完为止



Business Account

WhatsApp +65 8710 7707



www.707-inc.com

Favored ★★★★★ Sold 108 008

所提供的行程及价格仅供参考, 最终行程可能根据实际情况进行调整。受条款及细则约束。*

The provided itinerary and price are for reference purposes only; the final itinerary may be adjusted based on the actual circumstances. Terms and conditions apply. *